

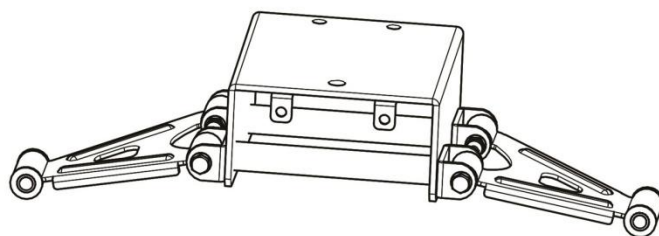

After installing this lift kit, the front wheels must be properly aligned. Failure to properly align the front wheels may result in decreased ability to control the Golf Cart which may result in a rollover or crash.

6" HD A-ARM SUSPENSION W/T SHOCKS

EZGO RXV 2008 AND UP



1. MAIN SUSPENSION ASSEMBLY

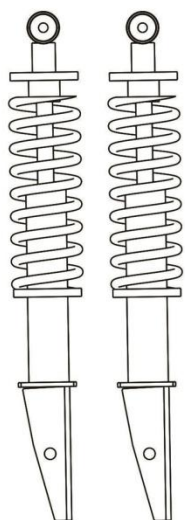

4. FRONT SHOCKS

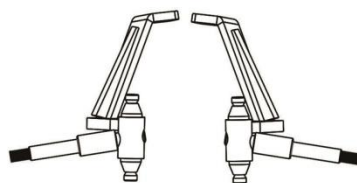

2. SPINDLES



3. SPACERS



5. SGC PLATE

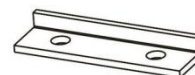

6. MOUNT BRACKET

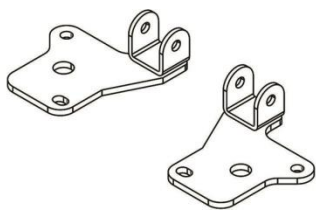

7. REAR SHOCK PLATES

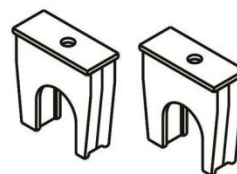

8. REAR RISERS

PARTS 7 AND 8 ARE FOR EZGO RXV 2008-2013 ONLY

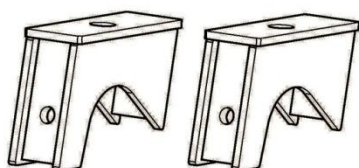

9. REAR RISERS



10. BRAKE CABLE BRACKET

PARTS 9 AND 10 ARE FOR EZGO RXV 2013+ ONLY

Bag#	Application	Spec.		Qty.
1	Main suspension assembly	Hex bolt	M16x50	1
		Lock nut	M16	1
		Flat washer	16	2
		Spacer		1
2	Mount bracket	Hex bolt	M10x100	2
		Lock nut	M10	2
		Flat washer	10	4
3	Front shock to lower a-arm	Hex bolt	1/2-13X4	2
		Lock nut	1/2-13	2
		Flat washer	1/2	4
4	Front shock	Spacer		2
5	Heim joint	Heim joint	1/2-20 x50	4
		Hex nut	1/2-20	8
		Flat washer	1/2	8
6	SGC Plate	Philip screw	M8x16	2
		Lock nut	M8	2
		Flat washer	8	2
7	Front hub	Flat washer	16	2
8 RXV 2008-2013 ONLY	Rear riser	U Bolt (square)		2
		Lock nut	M10	6
		Flat washer	10	6
9 RXV 2013+ ONLY	Rear riser	U Bolt (round)		4
		Lock nut	3/8	8
		Flat washer	3/8	8

After installing this lift kit, the front wheels must be properly aligned. Failure to properly align the front wheels may result in decreased ability to control the golf cart which may result in a rollover or crash.

Also please pay attention if factory hub has rust or wear. It will damage spindle during ride. We suggest you replace with new hub if rust and wear.

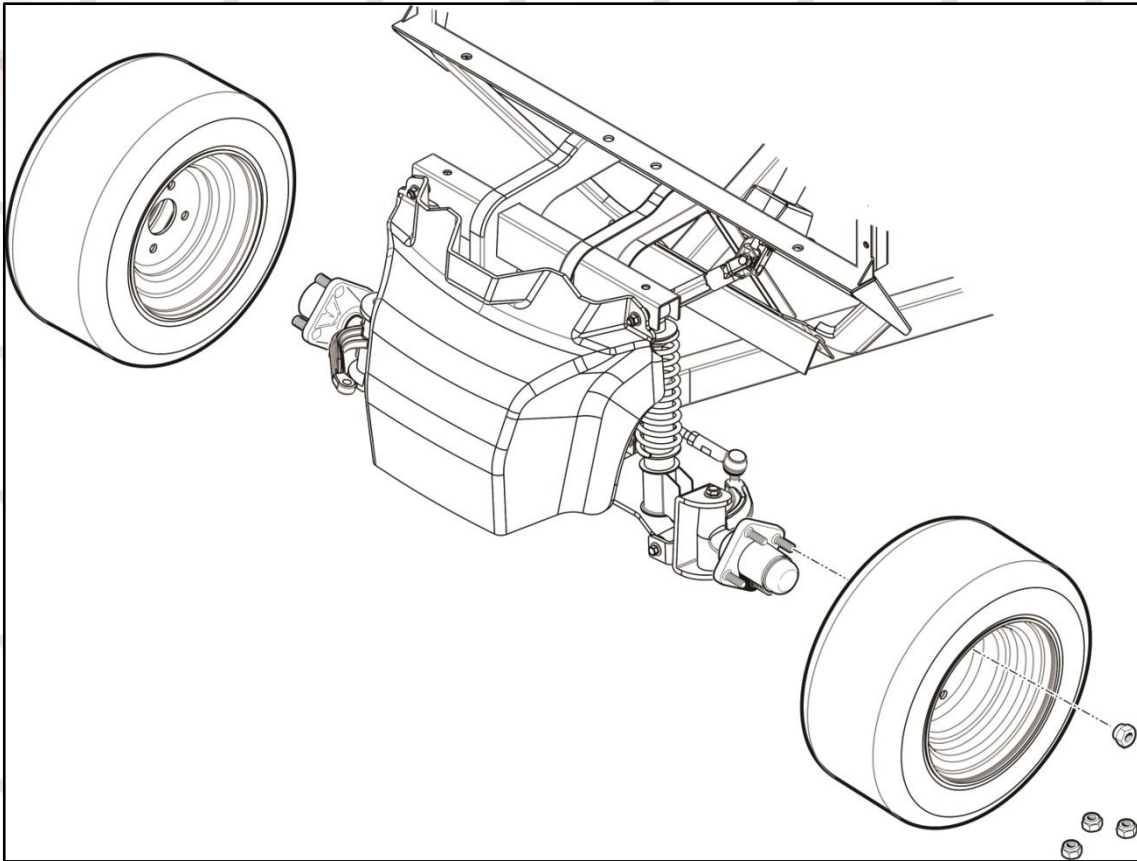

1. Remove front wheels from hubs.

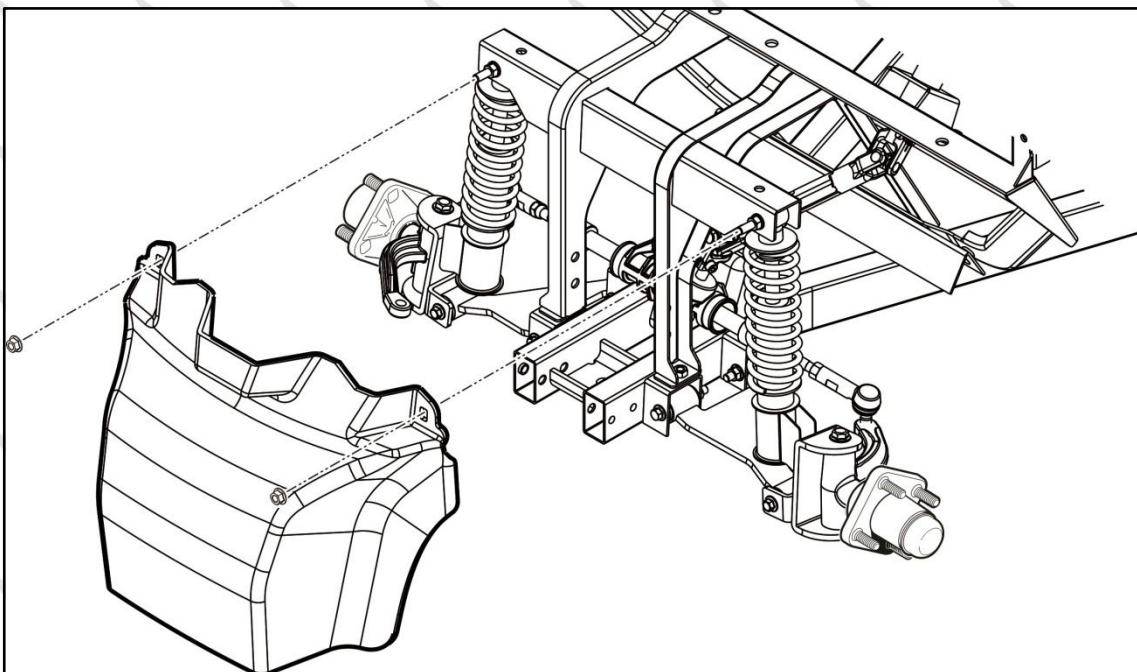

2. Remove front bumper from cart frame. Retain hardware.

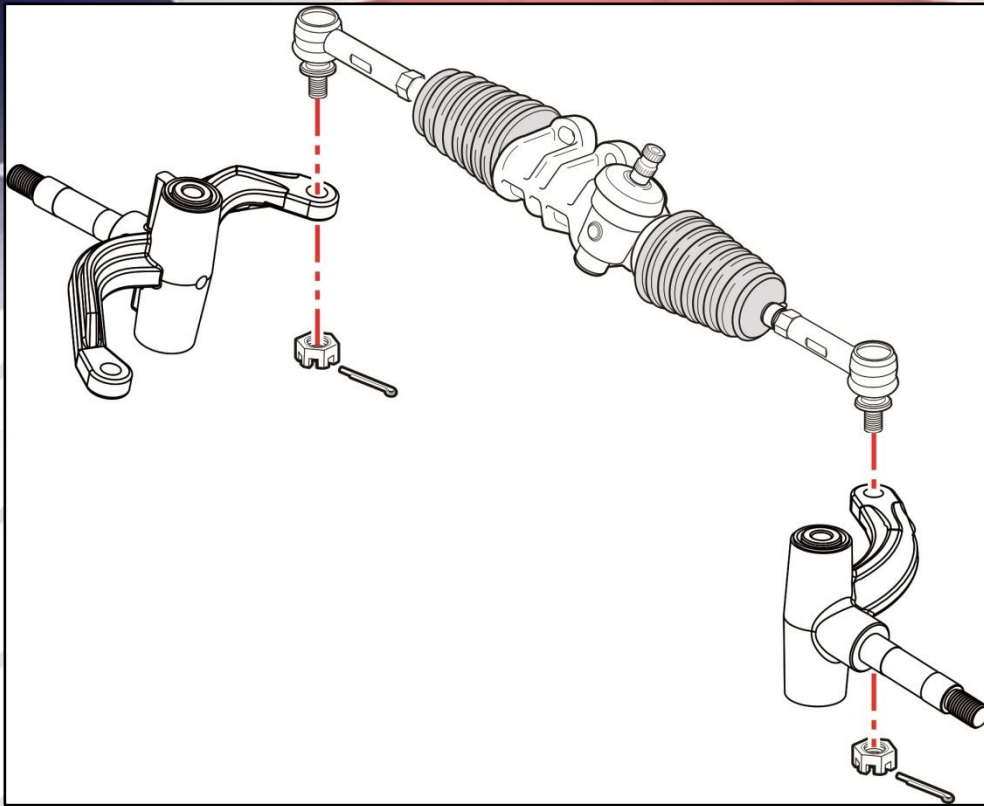

3. Remove rack and pinion from both spindles. Retain hardware.

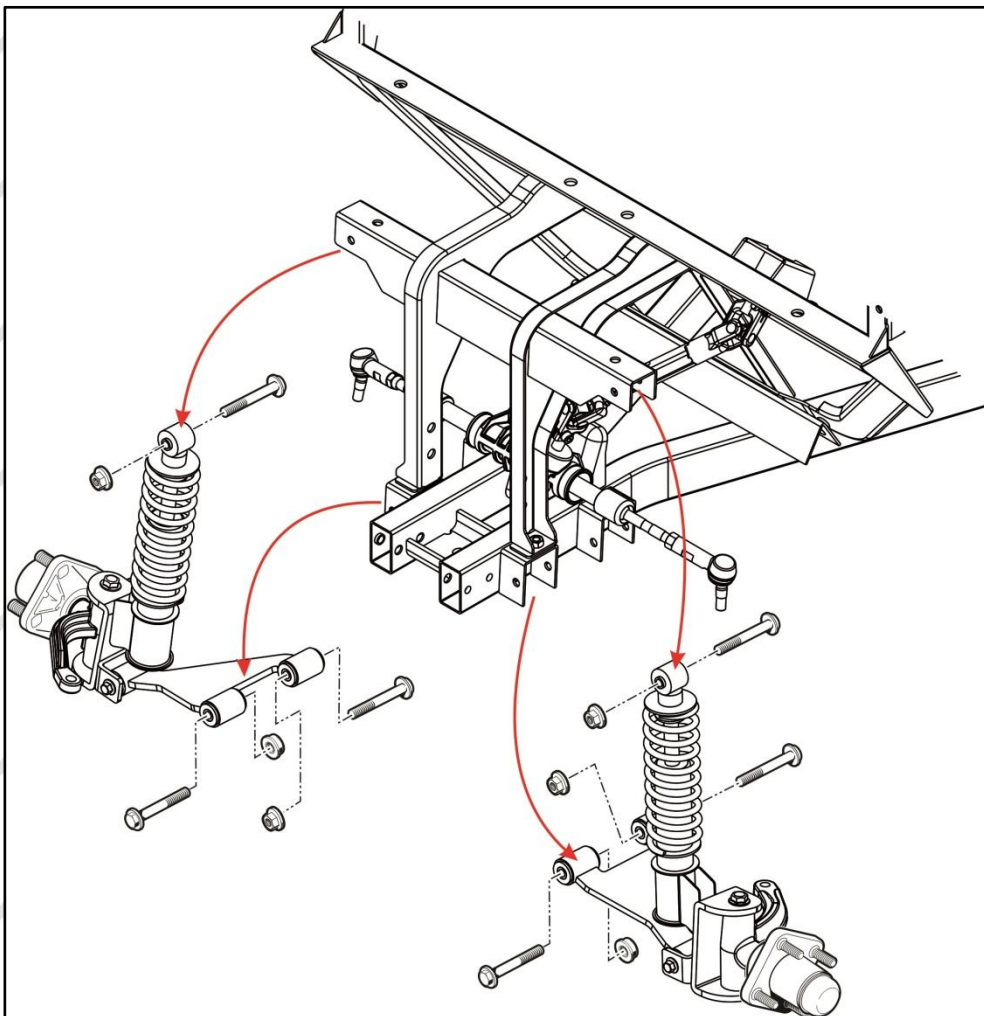

4. Remove front shock assembly from cart frame. Retain hardware.

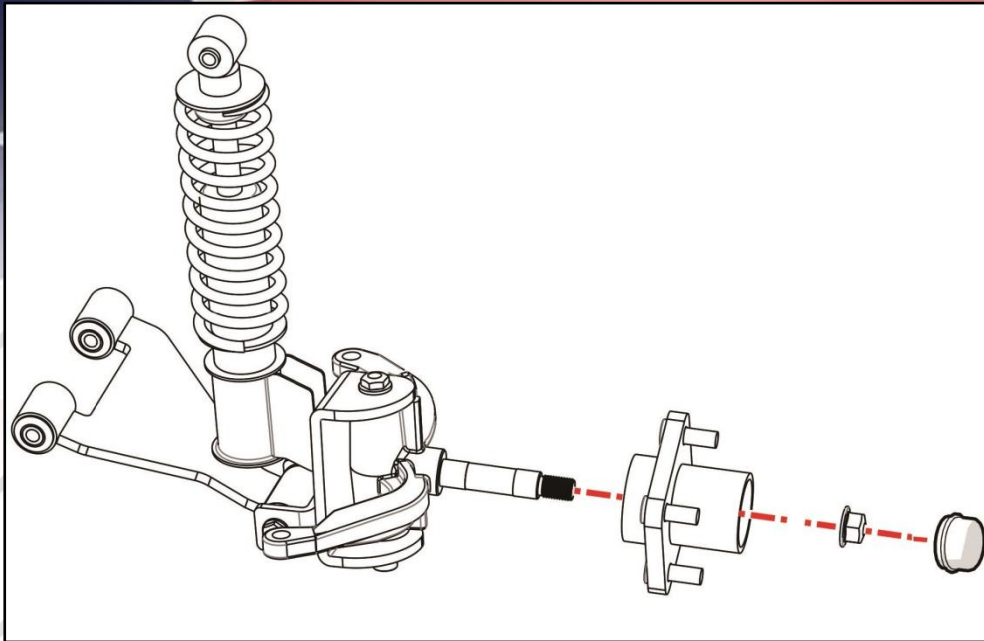

5. Remove hub from factory spindles and retain hardware.

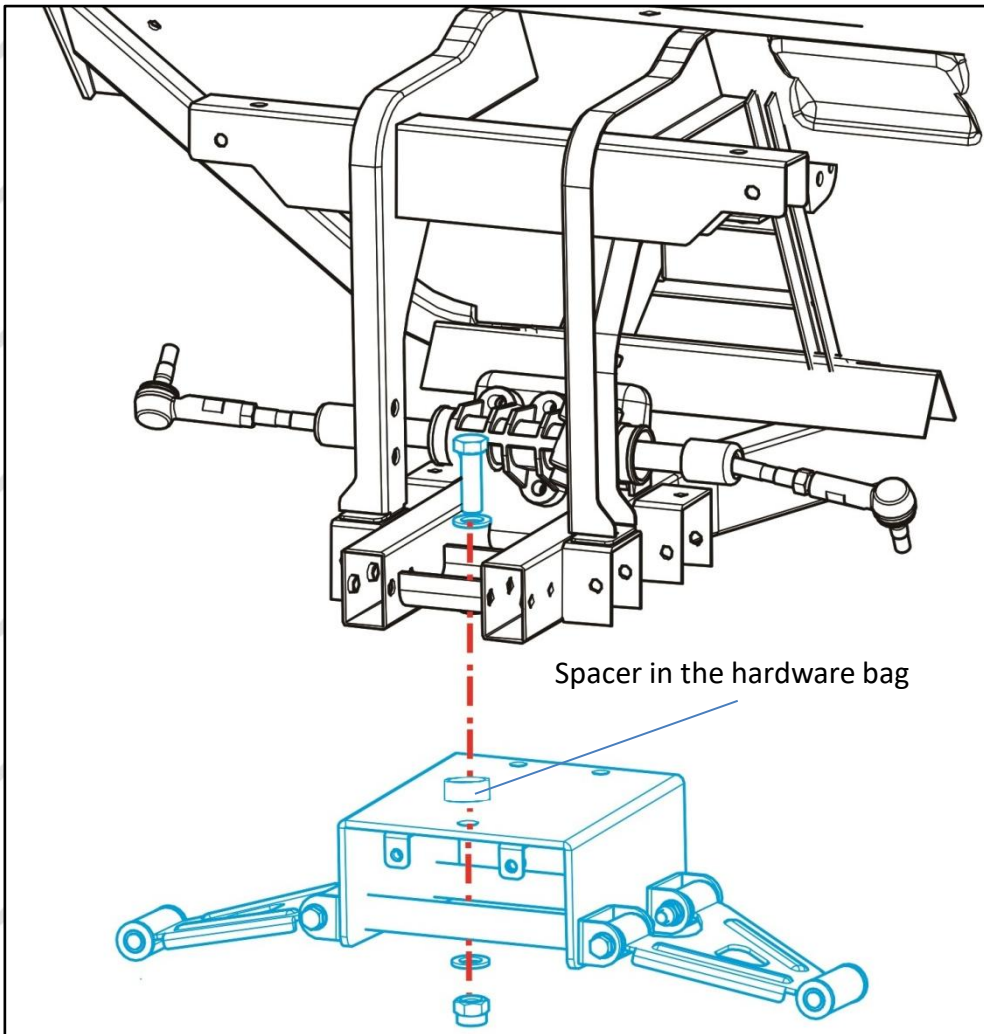

6. Attach main suspension assembly (part#1) to cart frame using hardware #1. Spacer in the hardware bag is placed as indicated.

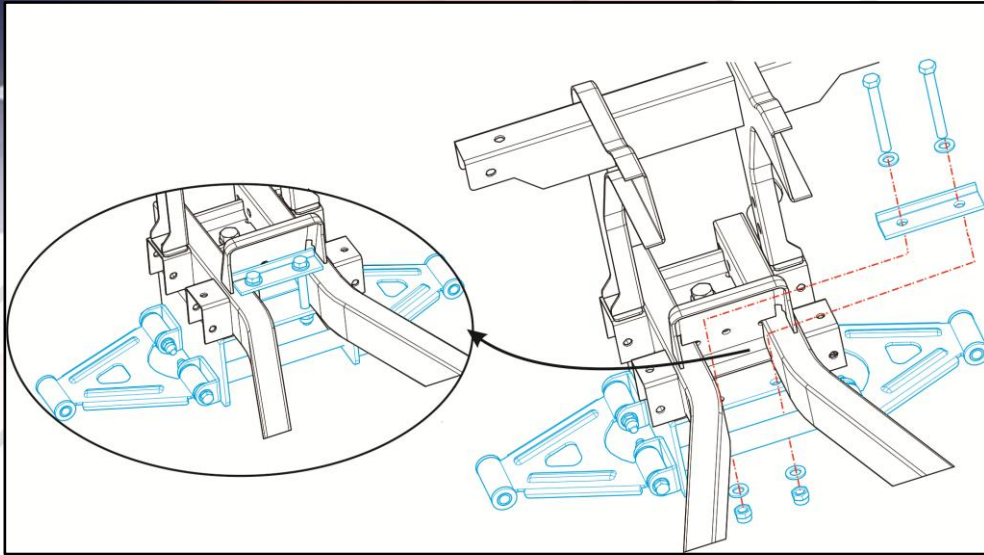

7. Further secure the main suspension assembly with mount bracket (part#6) on top of cart frame using hardware #2.

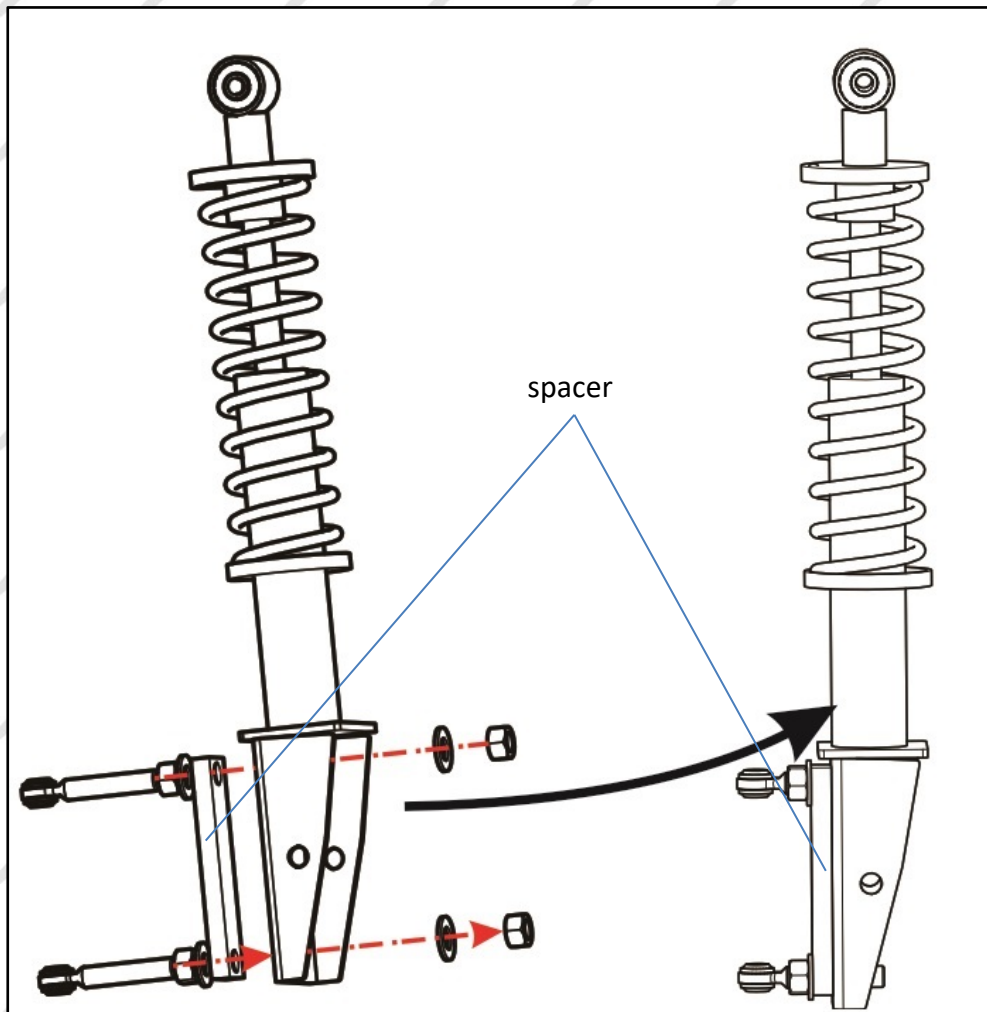

8. Attach heim joint and spacer to lower portion of front shock (part#4) using hardware #5.

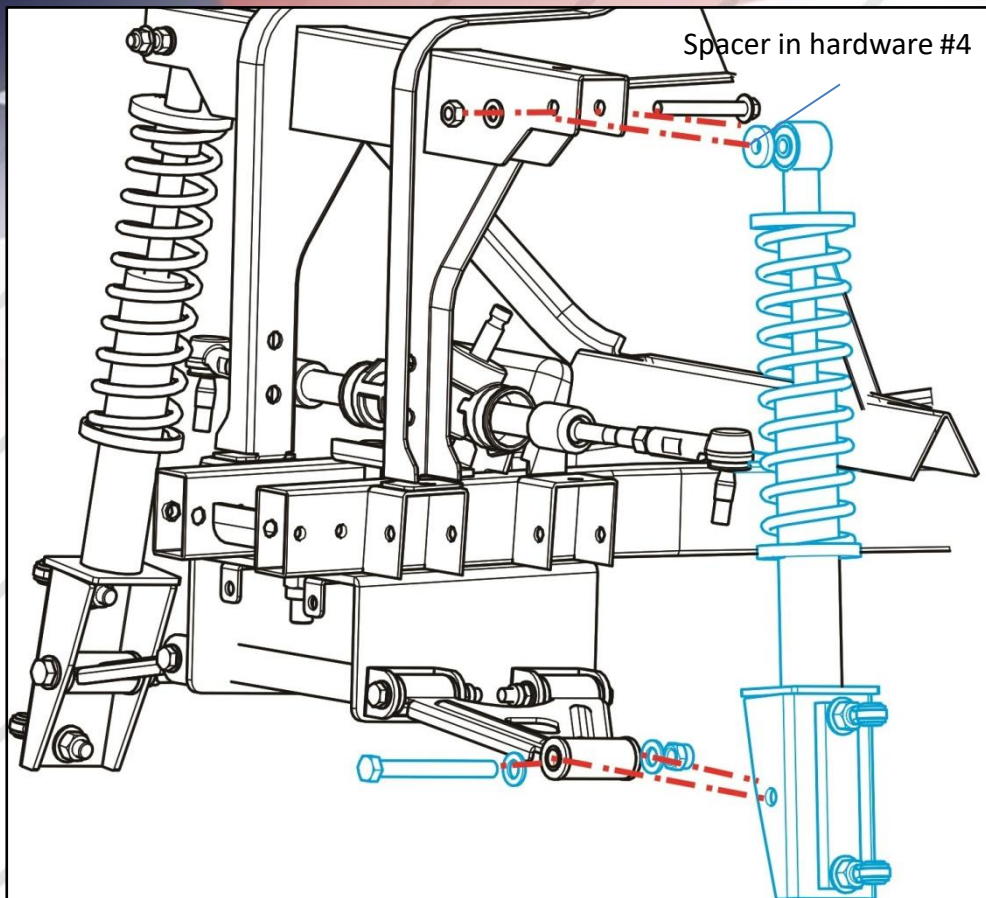

9. Attach front shock assembly to lower a-arm using hardware #3. Attach top eyelet of the shock to cart frame with supplied spacer in front in bag #4 and factory bolts and nuts.

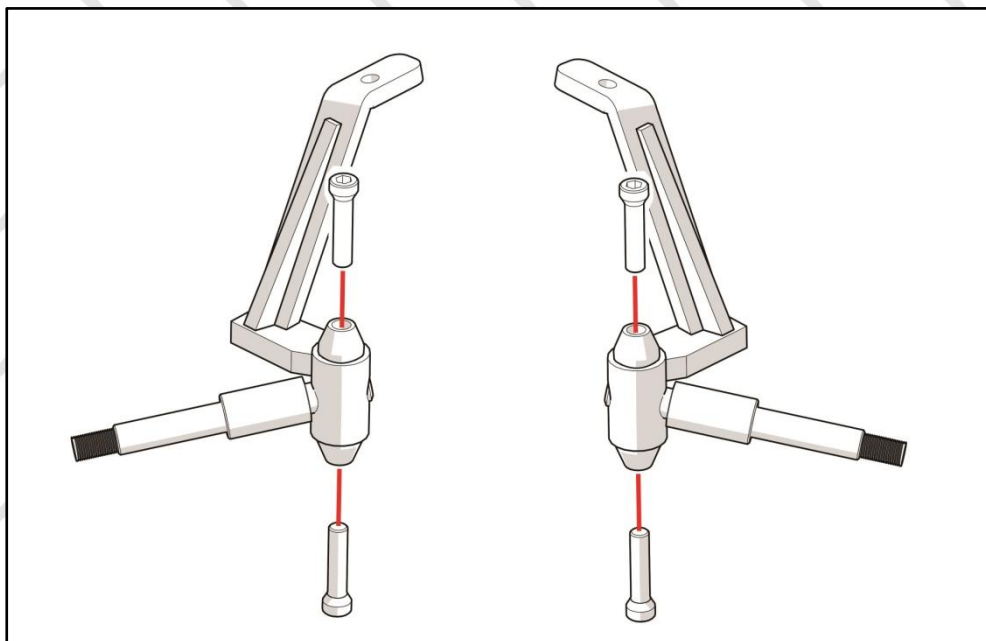

10. Loose pre-mounted bolts from spindles (part#2) and prepare for next step.

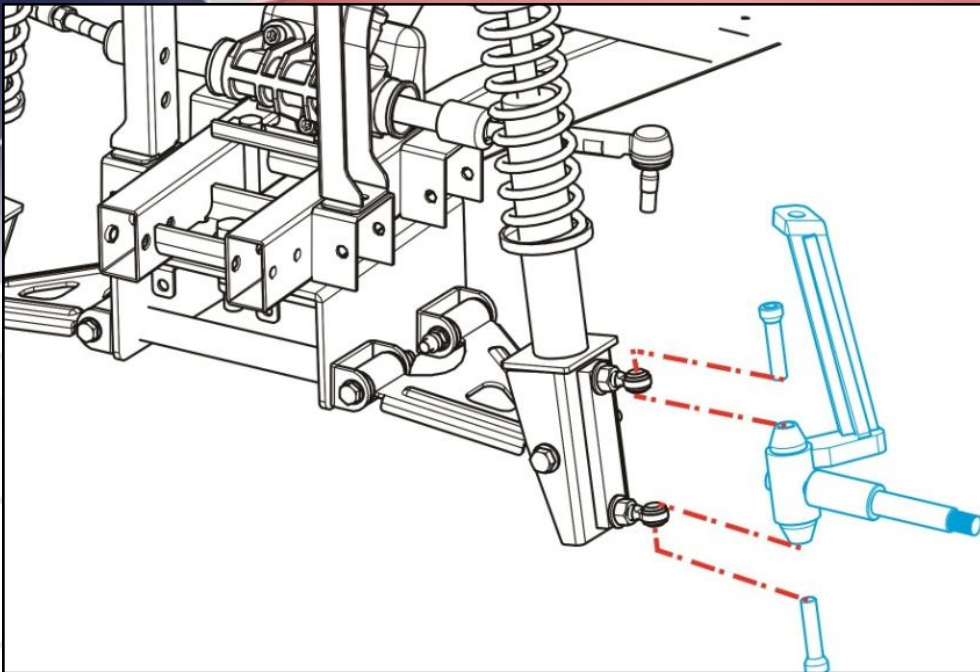

11. Attach spindles to heim joints using hardware from last step.

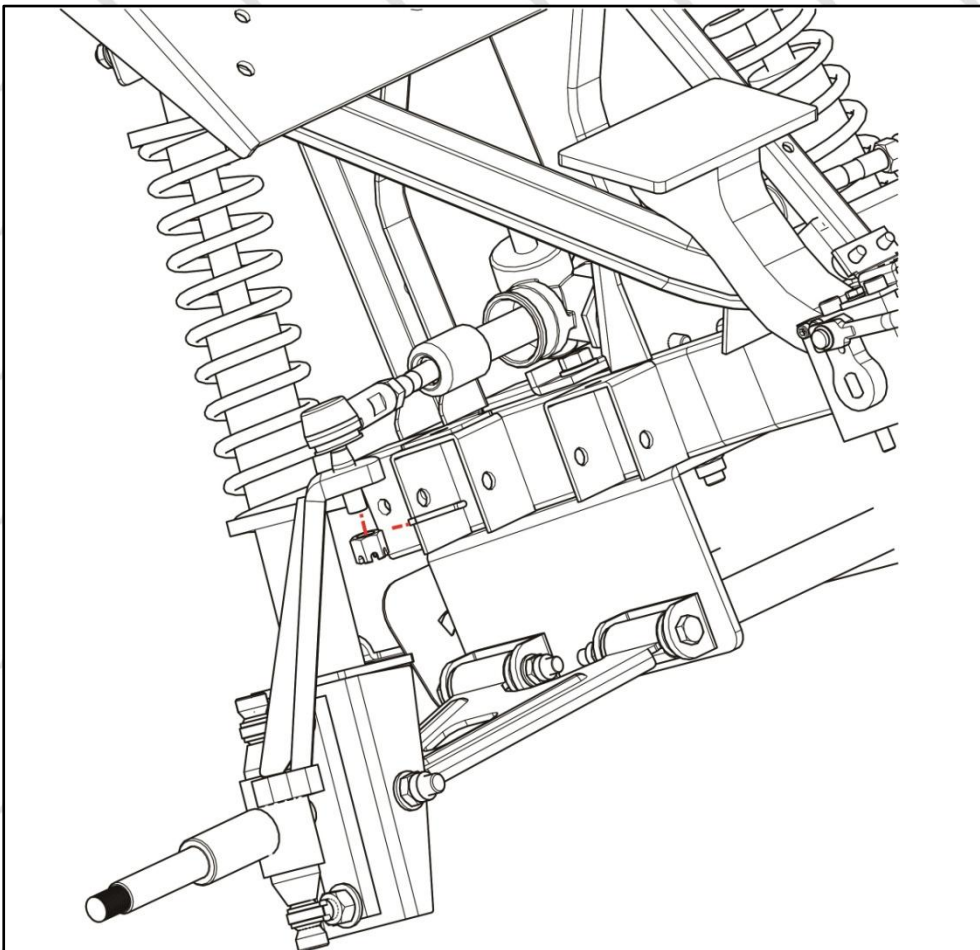

12. Attach tie rod end to new spindles using factory hardware.

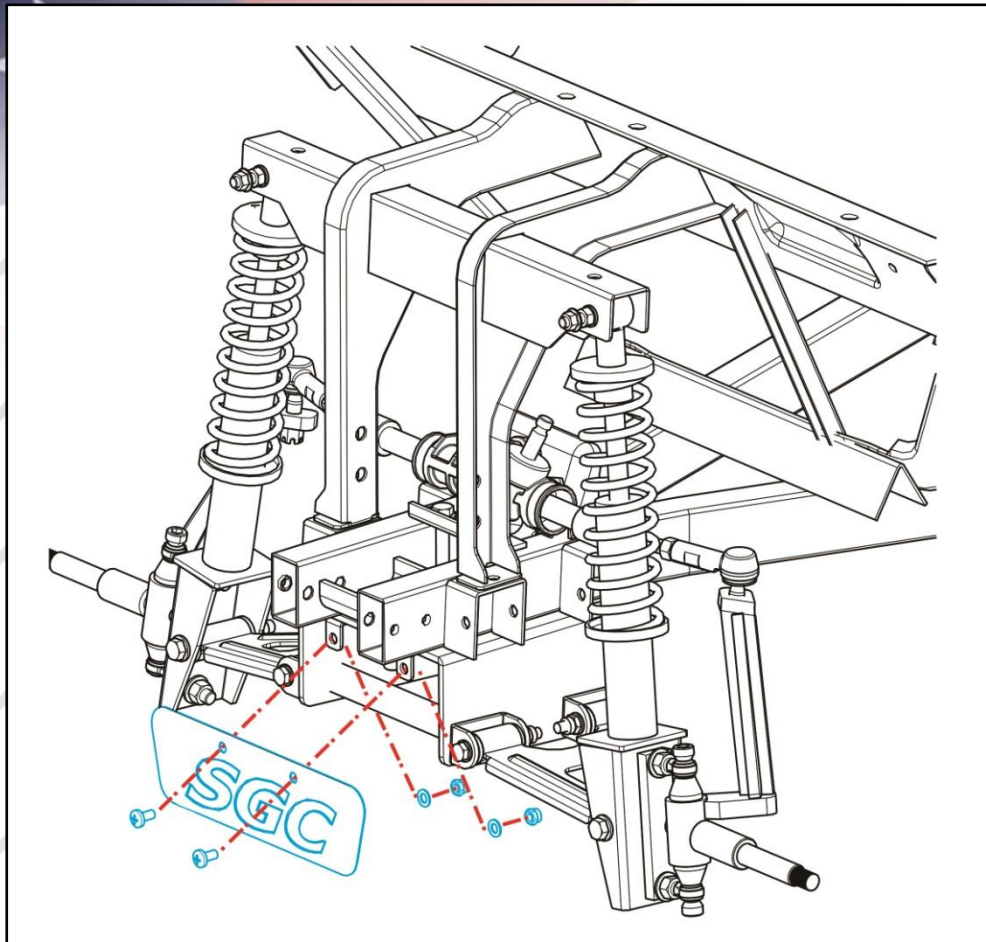

13. Attach SGC plate (part#5) to main suspension assembly using hardware #6.

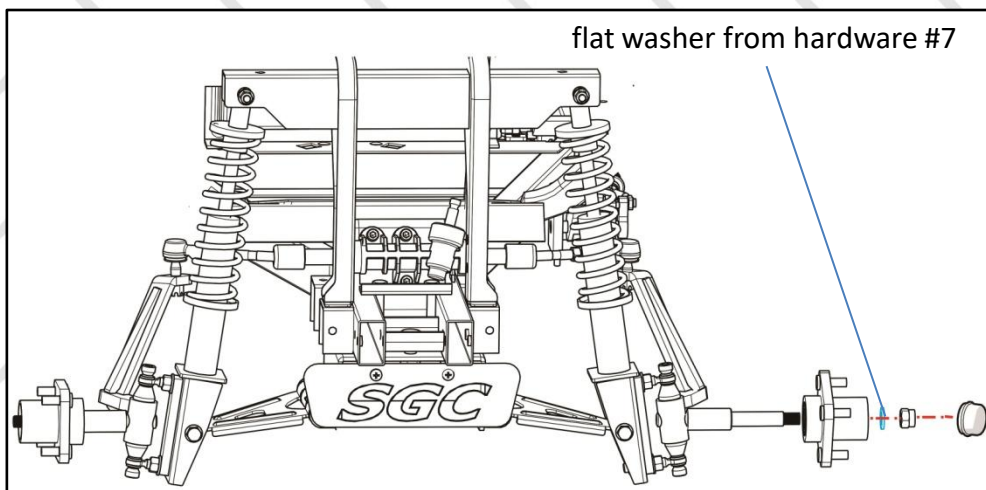

14. Reattach front hub to spindles with factory hardware and flat washer from hardware #7.

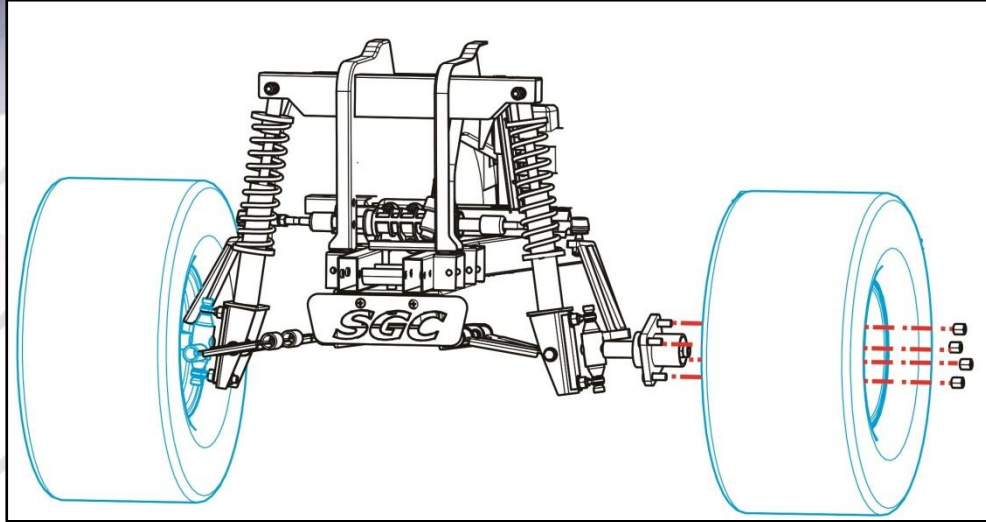

15. Re-attach front wheels to front hubs. Front installation finishes.

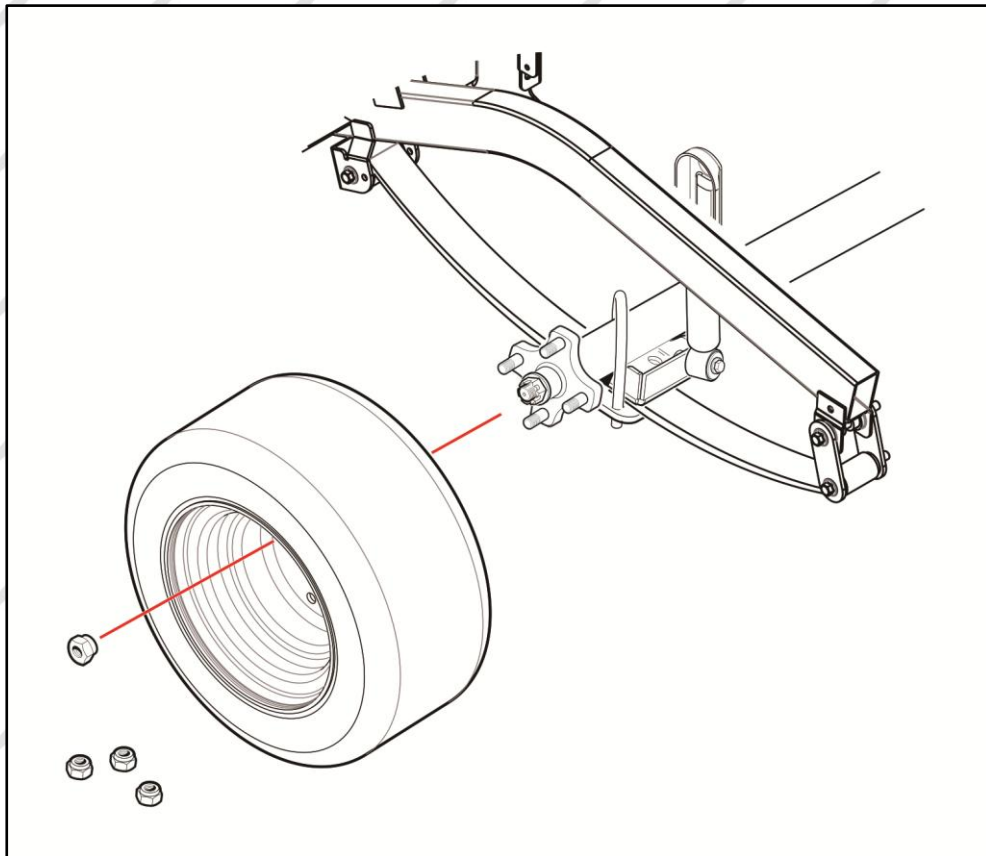

16. Remove rear wheels from rear hubs.

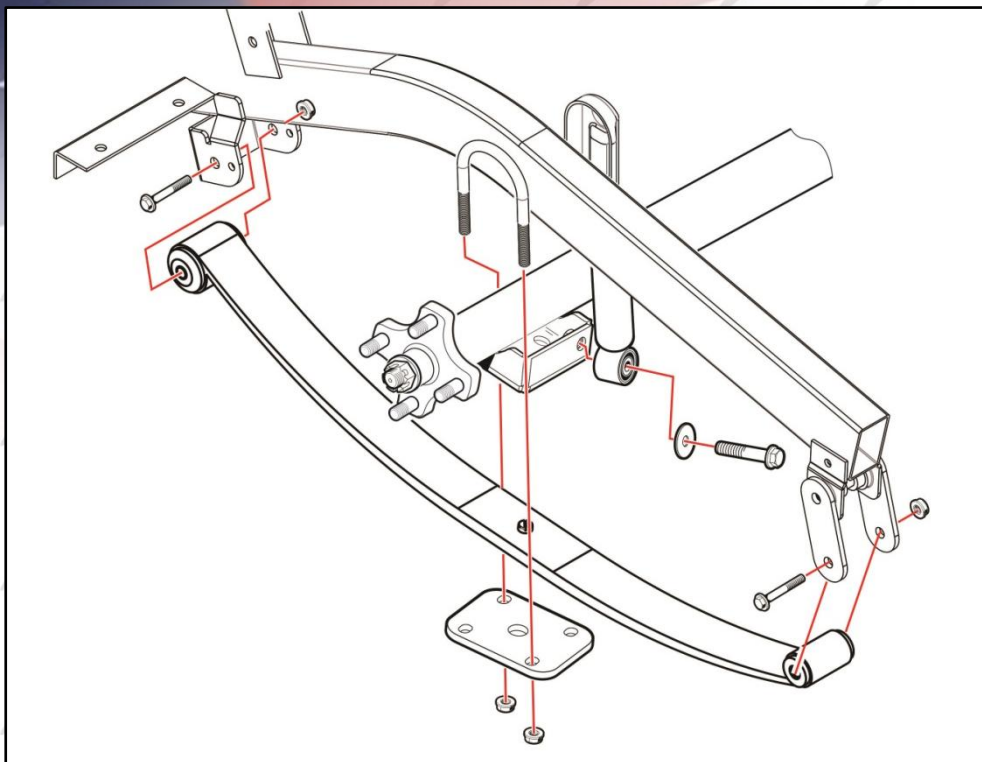

17. Loosen rear shocks and remove rear leaf springs from spring shackles. If you are riding a RXV 2013+, skip to step 20.

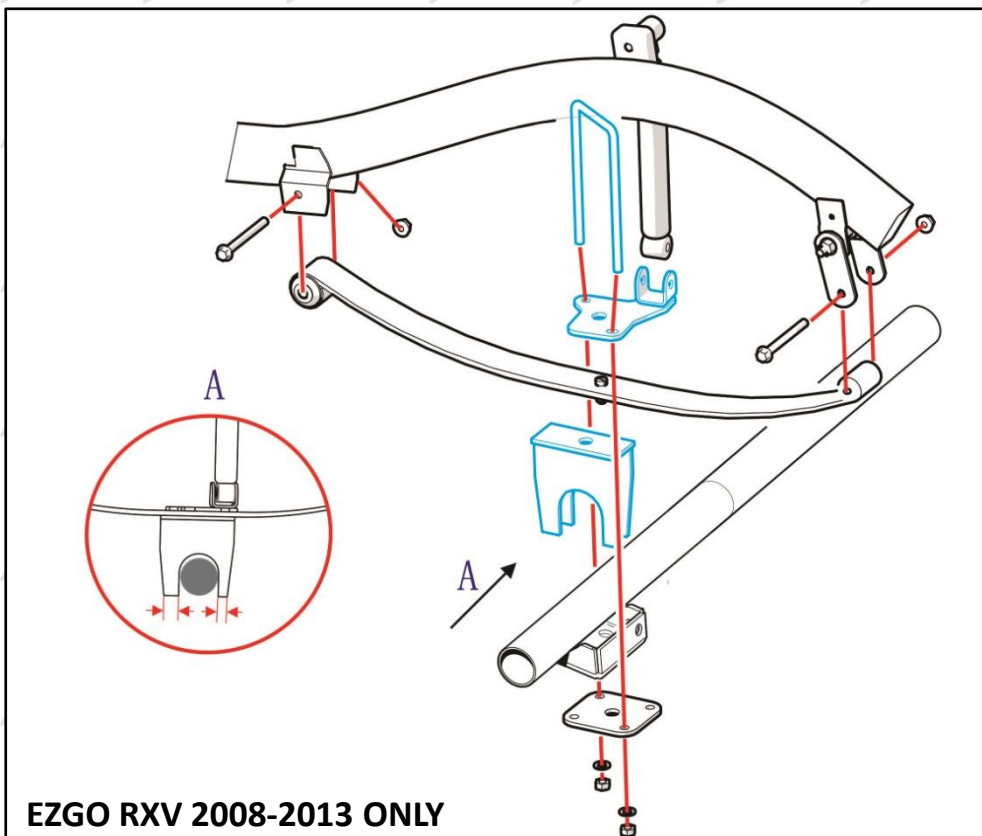

18. Sit rear riser to rear axle perch. Place rear leaf spring on the rear riser (part#8). Attach rear shock plate (part#7) on the leaf spring using U-bolts from hardware #8 to secure as indicated.

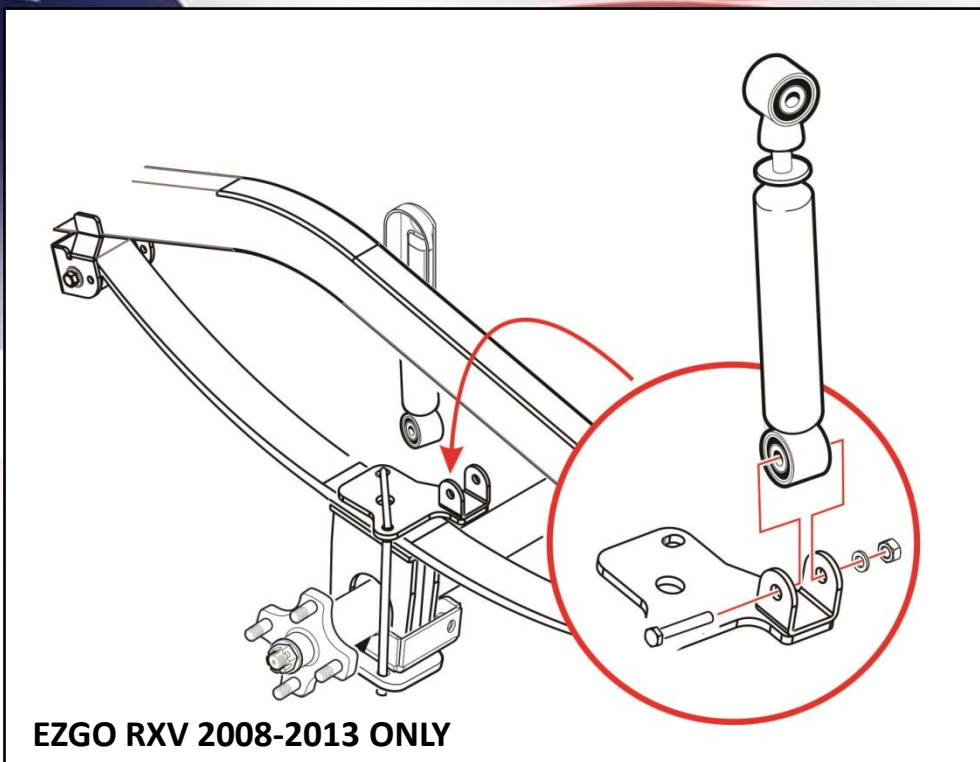

19. Attach lower eyelet of rear shock to rear shock plate using factory bolt and remaining lock nut and washer from hardware #8.

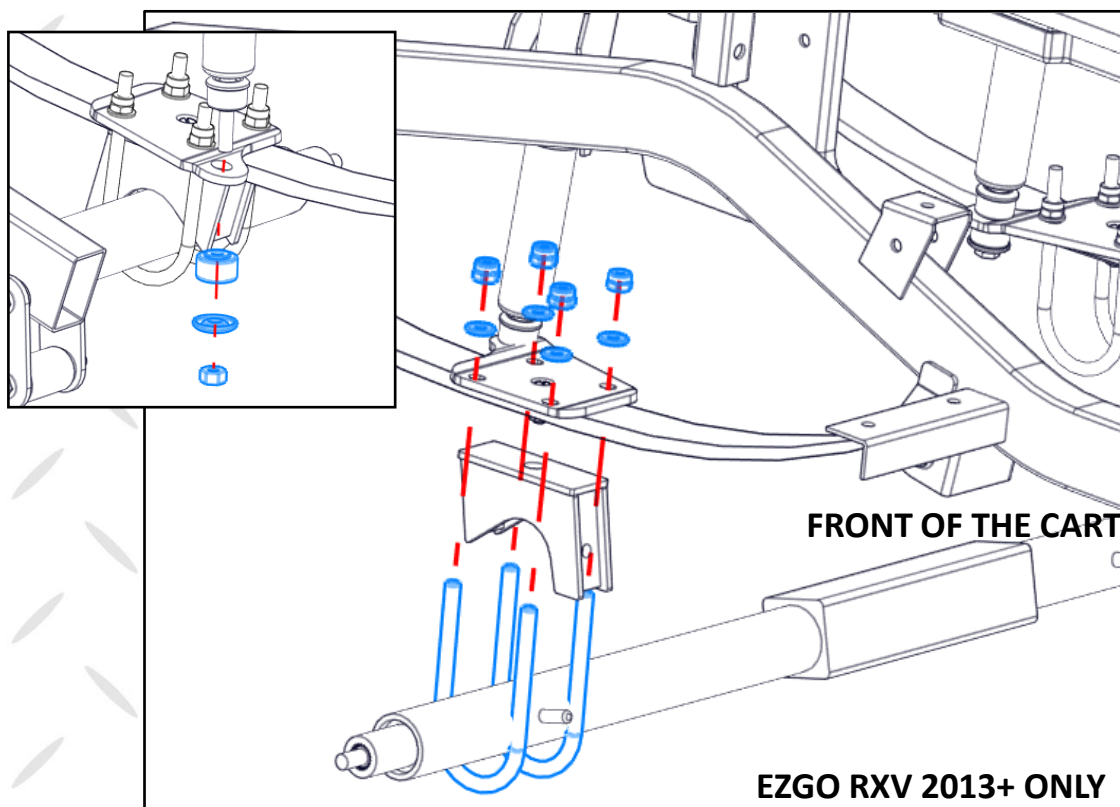

20. Sit supplied rear riser on rear axle and under factory rear leaf spring. The bolt head on leaf spring will fit into the top hole of the rear riser. Attach lower end of rear shock to factory rear shock plate. Use U bolt to attach these parts together. If the driver side brake cable is mounted on top of the axle, swap the rear brake cable bracket with the new one included in this kit.

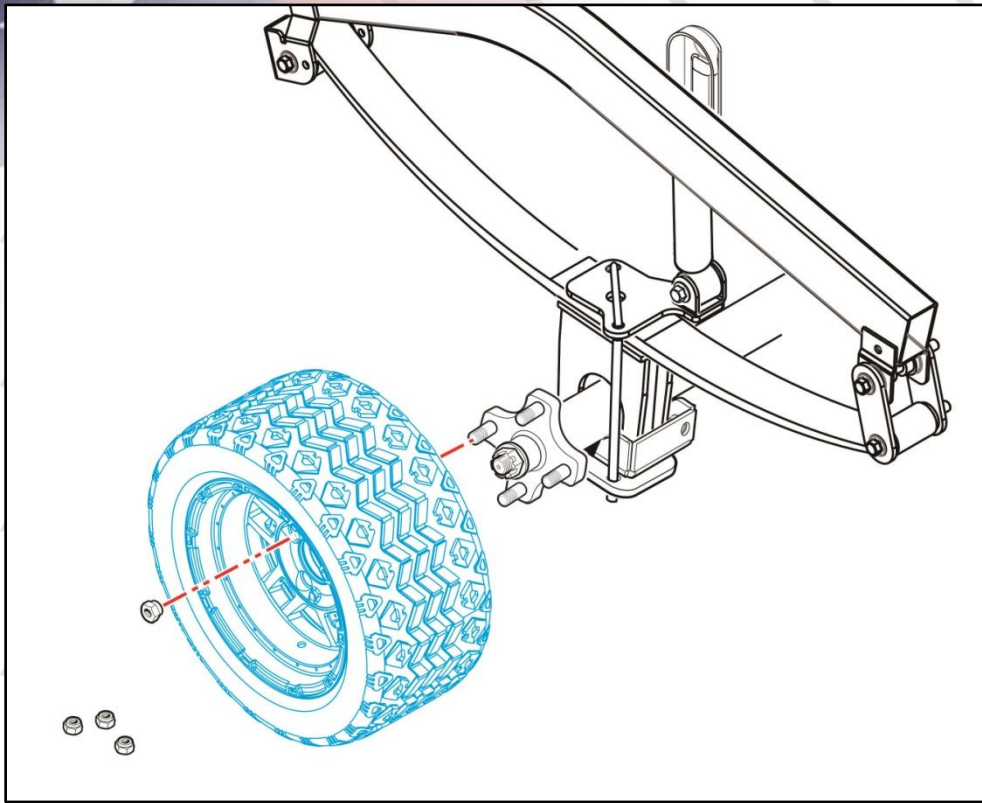

21. Reattach rear wheels.

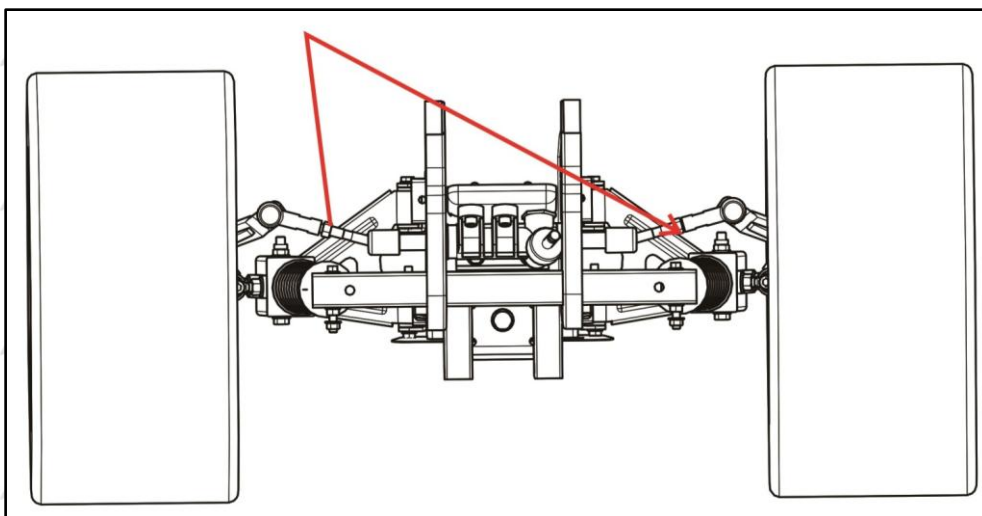

22. Adjust camber and toe.

IMPORTANT: Be sure to re-tighten all adjustment points after adjustments are made.

To adjust toe, ensure the wheels are pointing straight forward. Find a common point to measure from on the inside front and inside rear of the front tires. Adjust until the rear measurement is 1/4" to 3/8" greater than the front measurement.

Loosen nut on both tie rod ends. Adjust using a wrench to desired alignment.

If steering wheel is not properly oriented after adjusting toe-in, adjust steering box tie rod to align steering wheel if needed. Loosen tie rod lock nuts and turn steering box tie rod clockwise or counter clockwise to adjust steering wheel.

IMPORTANT: Ensure that after this adjustment, both wheels toe out from the cart's centerline equally. Once tightened, roll the cart back 15-20 feet and then forward again to check.

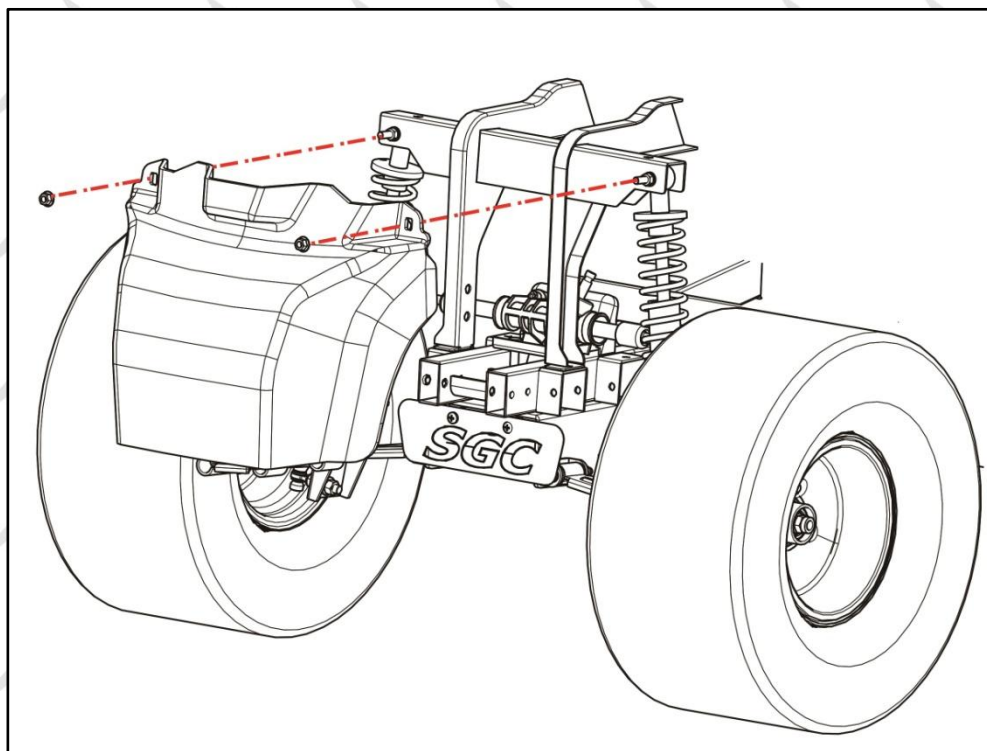

23. With adjustment finish, re-attach front bumper with factory hardware. Installation finishes.



RETURN MERCHANDISE AUTHORIZATION

Dear Valued Customer,

Thank you for choosing Steeleng Golf Cart Accessories for your golf cart needs.

We apologize for the issues you are having with your purchase. We strive to offer the absolute best quality at the absolute best price.

To best serve you, we do need a little information to help process your return and/or exchange faster.

Please complete the following and include this entire form with your return.

Name

Shipped To Address

STATE

ZIP

Purchased with:

eBay

Direct Phone Order

This is for

EXCHANGE

REFUND

Please describe reason for return:-

Our Return Address:

Steeleng Golf Cart Accessories

3309 Laurens Road,

Greenville, SC 29607

Tele: 864-675-1103

For Office Use Only:

Received By: _____

Date _____

Refund Amount _____

Exchange Issued _____

**Steeleng Golf Cart Accessories reserves the right to charge a 15% restocking fee for all returned and/or exchanged items.